

Short Roller Ball

WWW.GRISK.COM



DS-01 Series

Replaces the Dome Switch



- ◆ 360° of ball access, provides smooth travel of the plunger for longer life and better reliability
 - ◆ Screw down flange
- ◆ Travel distance total .200, pre-travel is $.080 \pm .030$
 - ◆ 12" #22AWG leads or screw terminals
- ◆ Longer leads, zip cords or jacketed cable upon request
 - ◆ Hermetically sealed
 - ◆ Plated contacts resist sticking or freezing
 - ◆ Spacers and mounting hardware included
- ◆ Built-in E.O.L. Resistors and Diodes upon request
 - ◆ Additional spacers sold separately
 - ◆ Supervisory loops upon request
 - ◆ Colors: white and brown
 - ◆ Lifetime Warranty



DS-01



DS-01T

	<u>Part Numbers</u>	
	<u>Closed Loop</u>	<u>SPDT</u>
12" Wire Leads	DS-01	DS-03
Terminal Block	DS-01T	

WARRANTY: Lifetime warranty against workmanship, material and factory defects.

GEORGE RISK INDUSTRIES, INC.
G.R.I. PLAZA
KIMBALL, NE 69145
WWW.GRISK.COM



Made in U.S.A.

TOLL-FREE 1-800-445-5218
TOLL-FREE 1-800-523-1227
(308) 235-4645
FAX (308) 235-3561
E-MAIL: sales@grisk.com

Short Roller Ball

WWW.GRISK.COM



INSTALLATION APPLICATIONS

360° of ball access provides smooth travel of the ball downward resulting in longer life and better reliability. The shorter length of the body helps the installer by eliminating the need for a long, deep hole to allow for a switch housing. The collar is flanged to insure reliability with positioning and the positive retention when the switch is installed.

GRI's creation of the new short roller ball style switch uses a magnetic reed with a rolling ball to control the magnet. The ball plunger can be actuated from any direction. Our improved short roller ball switch is actuated when the ball rolls into the switch rather than simply being forced into the housing.

Important Note: GRI's improved DS and RB Series of products are not recommended for the bottom or side track of windows and doors.

DS-01

DS-01T

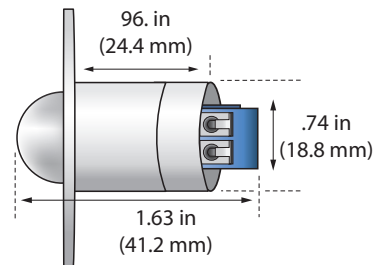
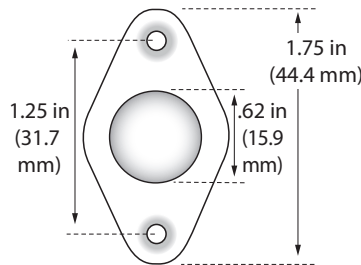
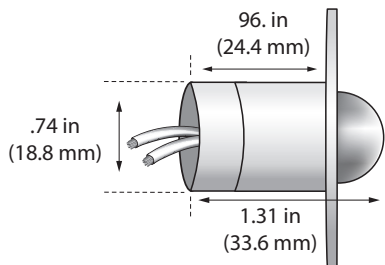

GRI PRODUCTS MEET OR EXCEED THESE MINIMUM GENERAL SPECIFICATIONS:

Part Number	Loop Type	Electrical Configuration	Reed Form	Max. Initial Contact Resistance (Ω)	Max. Contact Rating (W)	Max. Switching Voltage (VDC)	Max. Switching Current (A)
DS-01	Closed	N/O	A	.150	10	200	.500
DS-01T	Closed	N/O	A	.150	10	200	.500
DS-03	Open/Closed	SPDT	C	.140	5	175VDC	.250

WARRANTY: Lifetime warranty against workmanship, material and factory defects.

GEORGE RISK INDUSTRIES, INC.
G.R.I. PLAZA
KIMBALL, NE 69145
WWW.GRISK.COM



TOLL-FREE 1-800-445-5218
TOLL-FREE 1-800-523-1227
(308) 235-4645
FAX (308) 235-3561
E-MAIL: sales@grisk.com